

## Timothy [Tim] John Osborne

BSc(Hon), Mphil, CMLi, HKILA, RLA  
Director – URBIS Limited



Tim is a Director with over 35 years' experience (24 of which have been with URBIS) in a wide range of projects in Hong Kong, China, Malaysia, Australia & the UK, for both private and government clients. He is highly experienced in the design, implementation and management of large scales leisure, hotel, residential and infrastructure projects. He project managed the landscape design packages for The Venetian and Four Seasons Hotel Resort Casinos in Macau and also worked on the design and implementation of the signature lfc development and Four Seasons Place in Hong Kong. Tim is also extremely experienced in railway related development, having worked on numerous MTR and KCRC projects including the Express Rail Link (XRL), South Island Line (East) and Shatin to Central Link. He is also experienced in public realm streetscape and park projects and has a strong background in tree survey, preservation and risk assessment issues.

### EDUCATION / PROFESSIONAL QUALIFICATIONS

University of Exeter - BSc (Hons) Geography	1982-1985
University of Newcastle Upon Tyne - MPhil Landscape Design	1986-1988
Member of the Landscape Institute, UK (CMLi)	1992
Professional Member of the Hong Kong Institute of Landscape Architects	2023
Registered Landscape Architect	2022

### EMPLOYMENT

Jan 2004 –present	URBIS LIMITED, Hong Kong (Director)
2002 – 2003	KWOKKA PARTNERSHIP - Gold Coast, Australia - Senior Landscape Designer
1997 – 2002	URBIS LIMITED, Hong Kong – Landscape Designer
1996 – 1997	ARKILANDSKAP SDN. BHD., Kuala Lumpur, Malaysia - Landscape Architect
1994 – 1996	URBIS LIMITED, Hong Kong - Landscape Designer
1992 – 1993	NICHOLAS PEARSON ASSOCIATES, Bath - Landscape Architect
1989 – 1990	COMPANY OF DESIGNERS LANDSCAPES - Project Landscape Architect
1988 – 1989	MOXLEY JENNER LIMITED - Landscape Assistant
1986	GORDON PATTERSON & PARTNERS - Landscape Assistant

### SELECTED PROJECTS

#### HOTEL, LEISURE & COMMERCIAL PROJECTS



#### **MURRAY BUILDING HOTEL DEVELOPMENT AT 22 COTTON TREE ROAD, CENTRAL, HONG KONG**

Client: Harbour City Estates Limited

Provision of landscape administrative services for conversion of iconic former Government building into a hotel with a site area of 6,300 square meters. Services include tree survey, Tree Removal Application and bi-yearly status/assessment reports on large OVT; MLP submission; Detailed Design, Tender and site supervision. Landscape areas include site arrival and drop-off with sunken plaza and associated streetscape, podium dining and event gardens, and public open space.



#### **HONG KONG OBSERVATION WHEEL, CENTRAL WATERFRONT**

Client: Swiss AEX Holdings Limited

Scope includes conceptual master planning and detailed hard and soft landscape design for setting of proposed observation wheel on the waterfront at Central.



### **ROYAL HONG KONG YACHT CLUB, KELLETT ISLAND, CAUSEWAY BAY, HONG KONG**

Client: Royal Hong Kong Yacht Club

Tree protection works and hard and soft landscape concept design for external areas in and around Grade III listed yacht club building in Causeway Bay. Full soft landscape design and implementation services. Landscape areas include new leisure and dining terraces and roofs, play areas and historic waterfront foreshore.

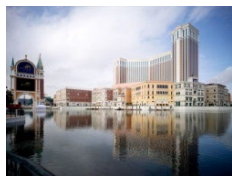

### **THE VENETIAN, MACAU, PRC - RESORT-HOTEL-CASINO**

Client: Venetian Macau Limited

Resort casino complex with hotel, convention and exhibition facilities developed on the theme of 'Venice.' Landscape areas comprise feature lagoon with terraces and promenade; swimming pool complex with leisure, spa and private function pools; podium landscape area with putting golf course and V.I.P. gardens; perimeter landscape.



### **FOUR SEASONS HOTEL, MACAU, PRC**

Client: Venetian Macau Limited

Six Star hotel located adjacent to The Venetian. Landscape areas comprise large swimming pool deck with 4 swimming pools, 2 spas, grotto feature, cabanas, & ornamental water features; Grand Entrance with porte cochere and water feature; podium landscape area with another pool deck and spa; Paiza Mansion courtyard garden; and several small terraced gardens.



### **HONG KONG STATION (IFC) DEVELOPMENT, HONG KONG**

Client: Central Waterfront Property Management Co Ltd

Hard and soft landscape design services for forecourt and podium/public open spaces for signature retail and commercial development on Central waterfront. High quality hard landscape detailing including arrival plaza, water features, seating and dining areas for restaurants, public open space and link bridges.



### **THE FOUR SEASONS HOTEL, CENTRAL, HONG KONG**

Client: Central Waterfront Property project Management Co. Ltd.

Hard and soft landscape design and implementation of high quality public open space adjacent to new Four Seasons Hotel in Central; design includes feature paving, walls, shelters and water features in public open space, hotel entrance ramp and plaza and link bridges to adjacent buildings.

## **RESIDENTIAL PROJECTS**

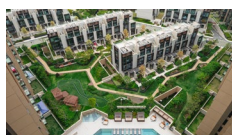

### **CRESCENT GREEN, 3 KO PO PATH, YUEN LONG, KAM TIN NORTH, HONG KONG**

Client: Road King Properties Holdings Limited

Full landscape design and implementation services for a new residential development comprising 11 13-storey towers and 26 houses with central club house and swimming pool. Site constraints include overhead MTRC West Rail viaduct and at grade DSD drainage reserve. MP, TPRP (inside and outside Lot) and SCC landscape submissions were required.



### **SAVANNAH, 3 CHI SHIN STREET, TSEUNG KWAN O, HONG KONG**

Client: Great Horwood Limited / Wheelock Properties (Hong Kong) Limited

Luxurious waterfront residential and retail development in the developing TKO East waterfront area. The development comprises 8 residential towers, 5 private houses, clubhouse and commercial facilities and has a site area of approximately 14,000 square meters. Services include tree survey, Tree Removal Application and MLP submission; Detailed Design, Tender and site supervision.

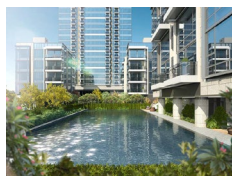

### **RESIDENTIAL DEVELOPMENT AT KOWLOON INLAND LOT NOS. 6516 & 6517, KAI TAK, KOWLOON**

Client: ACE Dragon Limited (subsidiary company of China Overseas Property Limited)

Full hard and soft landscape design and implementation services for luxury residential development in new urban redevelopment area of former Kai Tak Airport. Residential complex consists of mix of high-rise towers, exclusive low-rise apartments and residential units.



### **RESIDENTIAL DEVELOPMENT AT NOS. 44, 46, 48 AND 50 CHUNG HOM KOK IN STANLEY, HONG KONG**

Client: Shun Tak Development Ltd

Tree Survey, Tree Risk Assessment and full hard and soft landscape design services from concept through to implementation for luxury residential development.

## **EDUCATIONAL PROJECTS**



### **CHUNG CHI STUDENT DEVELOPMENT COMPLEX, THE CHINESE UNIVERSITY OF HONG KONG**

Client: Chinese University of Hong Kong

Soft landscape design for two new educational and residential blocks linked by aerial footbridge on the Chinese University of Hong Kong campus. The site is extensively covered with existing mature trees and tree preservation issues are critical. Services include a Tree Survey and Tree Protection and Removal Proposal.



### **SHAW MULTI-PURPOSE AUDITORIUM, HONG KONG UNIVERSITY OF SCIENCE AND TECHNOLOGY, HONG KONG**

Client: Hong Kong University of Science and Technology

Full hard and soft landscape design services for new iconic auditorium at the southern entrance of the campus. Services include tree protection and transplanting. Landscape features include high quality paved surrounds, memorial plaza/performance space and memorial garden/arena with small amphitheater, sunken lawn, smart light poles and benches.



### **REDEVELOPMENT OF ISLAND SCHOOL, 20 BORRETT ROAD, HONG KONG**

Client: ESF Island School

Full landscape softworks services for the redevelopment of a large International School on a prominent site in Mid-Levels. Services include tree survey and MLP submissions; concept, detailed and Tender design drawings; site supervision and implementation. The project is being implemented using BIM and the design is for a state of the art modern school environment embedding environmental sustainability. A co-creation process with staff and pupils is fundamental to the design development.



### **KELLETT SCHOOL, KOWLOON BAY CAMPUS, HONG KONG**

Client: Kellett School Association Ltd

Tree Survey, Tree Removal Application and transplanting services; full softworks landscape design including interior atrium planting, streetscape planting and roof "Skypitch" area. Design features include interior atrium tree planting, roof "Skypitch" garden with sports field, athletics track and perimeter amenity planting and streetscape tree planting.



### **NEW HARROW INTERNATIONAL SCHOOL, HONG KONG**

Client: Harrow International School

Preparation of a Landscape Master Plan Submission, a Tree Removal Application and detailed softworks design for the prestigious Harrow International School in the New Territories. Landscape elements include tree preservation, tree transplanting, structural screen tree planting, amenity tree and shrub planting, natural turf areas, courtyards and a large artificial turf sports field that forms the central design focus of the whole school.

## **GOVERNMENT/INSTITUTIONAL PROJECTS**

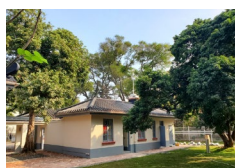

### **REVITALISATION OF THE LADY HO TUNG WELFARE CENTRE INTO THE LADY HO TUNG ECO-LEARN INSTITUTE, HONG KONG**

Client: DEVB & Sik Sik Yuen Lady Ho Tung Welfare Centre Eco-Learn Institute Ltd.

Revitalisation of Grade 2 historic building complex and surrounds into a unique local ecology discovery centre providing training programmes and activities to enhance public awareness of biodiversity, ecology and sustainable development. Soft landscape design services including tree survey, design of exterior area including organic farming, nature pond, paddy field, silk work farm and Chinese Herbal Medicine garden.



### **REVITALISATION OF OLD DAIRY FARM SENIOR STAFF QUARTERS, HONG KONG**

Client: DEVB & The Pokfulam Farm Company

Revitalisation of Grade 1 historic building complex and surrounds into "The Pokfulam Farm" – a living museum and platform to experience the social and cultural history of the old Dairy Farm and Pokfulam Village. Soft landscape design services including tree survey, design of exterior area including central lawn, amphitheatre and organic garden.



### **PRELIMINARY PLANNING STUDY FOR ADDITIONAL OFFICE ACCOMMODATION AT THE HONG KONG OBSERVATORY HEADQUARTERS**

Client: Hong Kong Observatory

Tree Survey, Tree Removal Application, LVIA and MLP submission for new administrative block options at the historic Hong Kong Observatory site in TST, Kowloon.





## REDEVELOPMENT OF CARITAS MEDICAL CENTRE, PHASE 2, HONG KONG

Client: Caritas

The redevelopment of medical centre in Shamshuipo including conceptual design, landscape master planning, detailed design and supervision. The landscape design developed for the project includes innovative design elements based around rehabilitation concepts. New landscape facilities include roof garden at new ambulatory and rehabilitation block, sensory garden, large passive open spaces, event spaces, greening of existing slopes and rationalisation of pedestrian and vehicular circulation.



## AGREEMENT NO. 9AX034 REPROVISIONING OF FEHD SAI YEE STREET VEHICLE DEPOT AT YEN MING ROAD, WEST KOWLOON RECLAMATION AREA, HONG KONG

Client: Architectural Services Department, HKSAR Government

The project involves full landscape design services from concept design through to detail design and implementation including tree protection/removal. The landscape design of the depot incorporates substantial vertical greening elements and a large roof garden with extensive and intensive green roof areas.

## INFRASTRUCTURE PROJECTS



## AGREEMENT NO. CE 18/2015 (CE) IMPROVEMENT WORKS FOR MOUNTAIN BIKE TRAIL NETWORKS IN SOUTH LANTAU DESIGN AND CONSTRUCTION, HONG KONG

Client: Civil Engineering and Development Department, HKSAR Government

Design and construction of improvement works to existing mountain bike trails on South Lantau for CEDD. Scope of works includes coordination with mountain bike trail design and construction specialist on consultancy team and supervision of term contractor for implementation of works. Main inputs include tree protection and survey work, signage and furniture design and implementation.

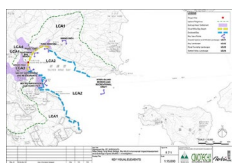

## AGREEMENT NO. WD 14/2014 - NEW WANG TONG RIVER BRIDGE, MUI WO - ENVIRONMENTAL IMPACT ASSESSMENT AND DRAINAGE IMPACT ASSESSMENT STUDIES

Client: Highways Department, HKSAR Government

LVIA services for new footbridge over the Wang Tong River in Mui Wo, Lantau. Services include preliminary landscape proposals, ACABAS submission and landscape and visual impact chapters of EIA.



## AGREEMENT NO. CE 42/2008(CE) - TSEUNG KWAN O - LAM TIN TUNNEL AND ASSOCIATED WORKS - INVESTIGATION

Client: Civil Engineering and Development Department, HKSAR Government

To undertake a Tree Survey and prepare a Tree Removal Application, conduct a Landscape and Visual Impact Assessment for an EIA and prepare preliminary landscape design proposals for the scheme.



## AGREEMENT NO. CE 87/2001(CE) - FURTHER DEVELOPMENT OF TSEUNG KWAN O - FEASIBILITY STUDY

Client: Territory Development Department

Planning, Urban Design and landscape design inputs to study into the feasibility of various development options for the extension of TKO and transport links to surrounding areas. Land Use Planning Study to formulate and evaluate development concepts and prepare a RODP for TKO and recommended layout plans for West Coast Road, Cross Bay Link, Area 137, Town Centre South, Pak Shing Kok and possible further reclamation, leading to preparation of ROZP with Explanatory Statement. Preparation of Master Landscape Plans and Master Urban Design Plans for the Study Area. LVIA for Schedule III Project and all Schedule II projects included in the development.



## SOUTH ISLAND LINE (EAST) - CONSULTANCY AGREEMENT NO.C903 WHO STATION, OCP STATION AND VIADUCTS

Client: MTRC Corporation Limited

Tree Removal Application and detailed hard and soft landscape design for alignment including two stations, viaducts, road improvements, reinstatement of existing public open spaces and design of new park areas including iconic footbridge.



## SHATIN TO CENTRAL LINK - CONSULTANCY AGREEMENT NO. C1106 - DETAIL DESIGN FOR HUNG HOM STATION AND ASSOCIATED TUNNELS

Client: MTRC Corporation Limited

New Rail Station and Interchange for the Sha Tin to Central Link with associated tunnels and railworks. URBIS scope includes tree removal application, ACABAS submissions, detail landscape design for slopeworks, rail and road corridors and public open spaces and amenity areas affected by the works.



## **EXPRESS RAIL LINK (XRL) CONSULTANCY AGREEMENT NO. C803 – DETAILED DESIGN FOR TUNNELS & ASSOCIATED STRUCTURES (NORTH)**

Client: MTRC Corporation Limited

Detailed Landscape Design for the temporary and permanent works of the northern section of the Express Rail Link from Beijing to Hong Kong. Design includes landscape mitigation for 4 no. vent shafts, a maintenance sidings depot and Emergency Rescue Area and compensatory habitat re-creation area.

## **TREE SERVICES**



## **QUOTATION CONTRACT NO. 26/2016/AB1 - CONSULTANCY FOR AUDITING OF TREE RISK ASSESSMENT 2016**

Client: Architectural Services Department, HKSAR Government

Auditing of 13 Form 1 and Form 2 tree risk assessments for around 407 trees undertaken by contractors on 5 new ArchSD works projects in 2016.

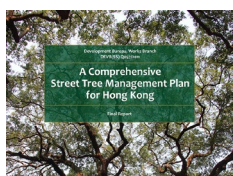

## **COMPREHENSIVE STREET TREE MANAGEMENT PLAN FOR HONG KONG**

Client: Development Bureau, HKSAR Government

Development of a comprehensive Street Tree Management Plan defining the framework and methodology for future management of street trees in Hong Kong so as to achieve a sustainable tree stock of high quality that maximizes the environmental, social and economic benefits that street trees offer to Hong Kong citizens, and that promotes public safety and minimizes risks associated with trees.



## **EXPRESS RAIL LINK - CONSULTANCY AGREEMENT NO. C8001 - TREE TRANSPLANTING / FELLING**

Client: MTRC Corporation Limited

Provision of support services to MTRC to obtain the route-wide Tree Removal Application approval for approximately 15,000 trees on the Express Rail alignment. Scope of works included design of temporary holding nurseries for transplanted trees; sourcing of permanent transplanting sites; preparation of compensatory planting proposals; preparation of tree removal application submissions; liaison with Government; tender documentation for tree transplanting contracts.

## **PARKS & OPEN SPACE / STREETScape PROJECTS**



## **CONSULTANCY AGREEMENT NO. 9AW 038 - LOCAL OPEN SPACE IN AREA 6, TAI PO AND DISTRICT OPEN SPACE AT THE JUNCTION OF HING WAH STREET WEST, LAI HONG STREET AND TUNG CHAU STREET**

Client: Architectural Services Department, HKSAR Government

The Tai Po LOS project is to provide sports and recreational facilities for local residents and students at the nearby schools including two basketball courts cum volleyball courts, a flower themed garden and a walking trail with fitness equipment for the elderly. The Shum Shui Po project is to provide an open space with sports and recreational facilities including a rest garden with soft landscape areas, a pet garden and a 7-a-side artificial turf soccer pitch.



## **ENHANCEMENT OF EXISTING TOURIST ATTRACTIONS IN CENTRAL & WESTERN**

Client: Architectural Services Department, HKSAR Government

Streetscape improvement works to historic parts of Central and Western to enhance the historic character, improve signage, and provide pedestrian facilities with a view to promoting tourism. Works include design of new Lok Hing lane sitting out area.



## **AGREEMENT NO. HQS 01/2004 - DEVELOPMENT OF GREENING MASTER PLAN FOR TSIM SHA TSUI AREA**

Client: Civil Engineering and Development Department, HKSAR Government

Development of a Greening Master Plan to define the overall greening framework, including establishing planting themes and identifying the extent and locations suitable for greening. The Greening Master Plan is a reference guide to all bodies involved in the implementation of greening work within the area, with a view to achieving an effective overall greening effect with local characteristics. The main objectives were to develop a Greening Master Plan and identify locations within the Study Area which were suitable for immediate implementation of pilot greening schemes. Detailed design packages were also prepared for pilot greening schemes for implementation by others.